

Exit Button

Art. No.: 480090 (black)
Art. No.: 480091 (white)
Art. No.: 480190 (black)
Art. No.: 480191 (white)

User Manual



Exitbutton_usermanual_ENGokt19



Table of Content

1. Introduction	page 3
2. Installation	page 3
3. Time and proximity range adjustment	page 4
4. Technical Specifications	page 5



1. Introduction

The exit button can be used for many different applications. The reader has a double color status light (green and red) and has an adjustable proximity range. The reader is touchless and is therefore suitable for access control systems in public areas such as hospitals or restaurants.

For Art. No. **480090** and **480091**, color of indicator light is adjustable:

In standby the LED ring lights red or green. When activated the LED ring will turn opposite color of standby light (red or green).

OBS. For these Art. No. only the 5 top wires are installed (red, black, yellow, white and blue)

The Art. No. **480190** and **480191** are with wires for external controlling of the red/green LED.

2. Installation

- Mount the reader on an even surface.
- Connect the wires to the power supply, lock unit, assembly box etc.
- Apply voltage 12 VDC, max. 24 VDC.

Note: Please make sure that there is no object (protection stickers included) or any obstacles within 30cm of the front panel to avoid any interference.

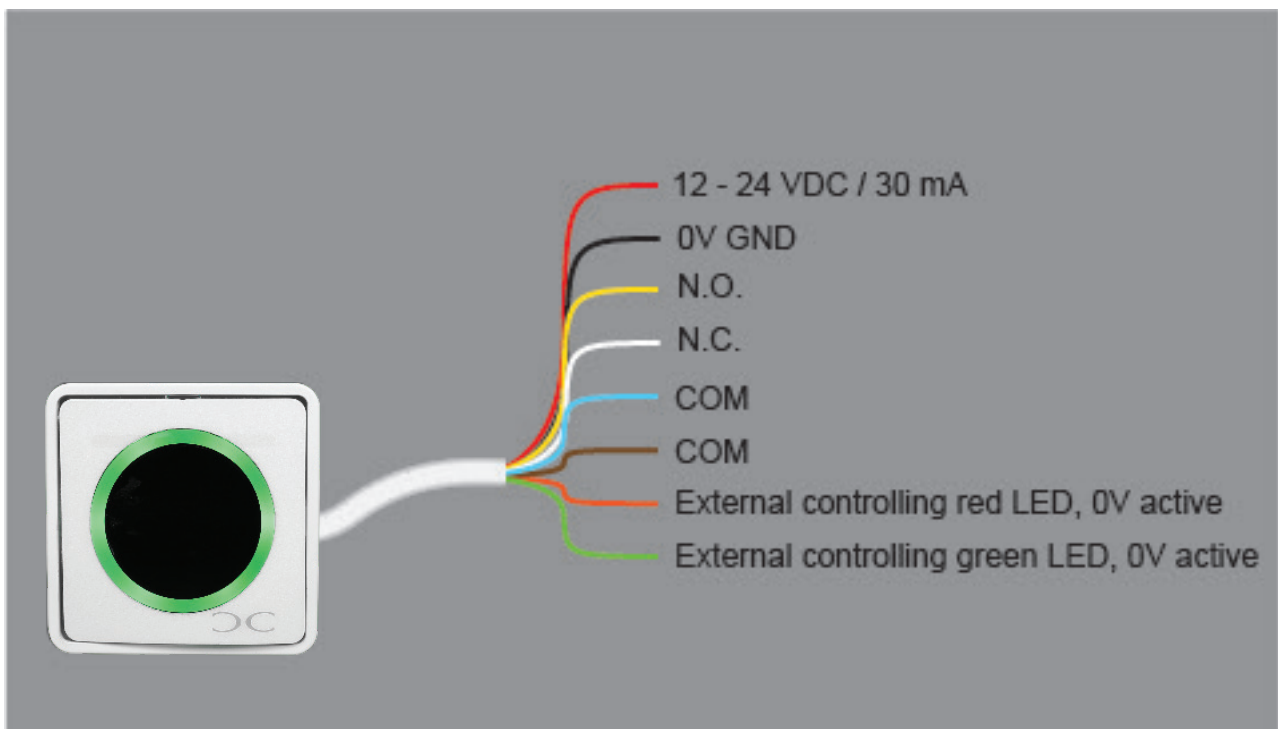



3. Time and proximity range adjustment

3.1 Adjustment

Time and proximity range are adjusted with the yellow dial. The top yellow dial adjusts the time and the the bottom one adjusts the distance.

When the arrow is placed as in the picture below, the reader is set to the shortest possible time / distance. Time / Distance is increased by rotating the yellow dial to the right.

Note: If the arrow on the dial for adjusting the time is set at the opposite end as in the picture, the time is set to toggle.

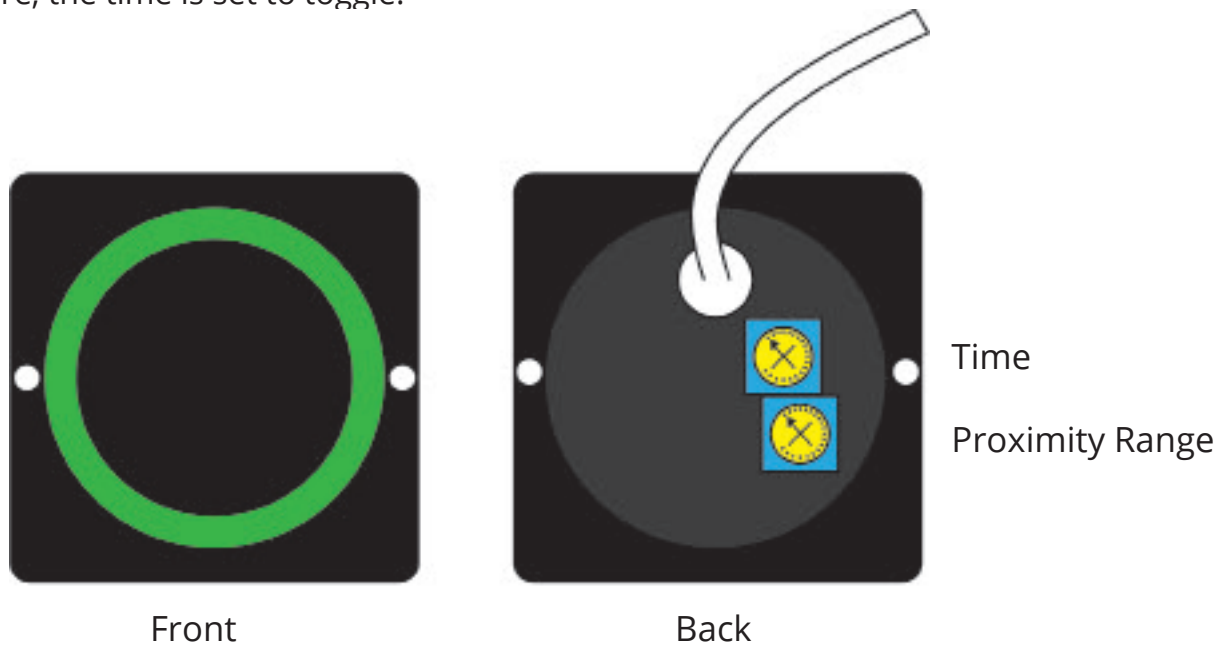

3.2 Time

For Art. No. **480090** and **480091**:

With these art. nr. you can set trigger state (0,5 seconds up to 30 seconds) or activate toggle mode output.

For Art. No. **480190** and **480191**:

With these art. nr. you can to set trigger state (0,5 seconds up to 30 seconds) or activate toggle mode output.



3.3 Proximity range

For Art. No. **480090** and **480091**:

You can set the proximity range from 4-15 cm. ($\pm 25\%$)

For Art. No. **480190** and **480191**:

You can set the proximity range from 3-12 cm. ($\pm 25\%$)

4. Technical Specifications

Voltage interval:	12 - 24 VDC, 30 mA
Relais:	
- NO	1A DC 30V (Max.)
- NC	1A DC 30V (Max.)
- COM	1A DC 30V (Max.)
Operating temperature:	-10°C ~ +70°C
Color:	Black or white
Dimensions (HxWxD):	50x50x8 mm

OBS. Dimensions can vary depending on chosen frame.

Thank you for choosing Conlan's products.

For further assistance, please contact
our support service.